

## **Salmistu sadam**

Kontaktisik: Andres Reisberg  
Firma: ARPE OÜ

Kuupäev: 22.09.2015  
Töötaja: Roland Tolk

Silmani Elekter AS

Kadaka tee 56  
TallinnTöötaja Roland Tolk  
Telefon 6711225  
Faks 6711221  
e-post roland@silman.ee

---

**Sisukord****Salmistu sadam**

Projekti tiitelleht	1
Sisukord	2
<b>WE-EF 195-9147 TRO259 IP55:LED-FT 12W/4K</b>	
Valgustite andmetabel	3
<b>WE-EF 132-0529 OLV334 [R65] IP65:LED-12/12W/4K</b>	
Valgustite andmetabel	4
<b>WE-EF 105-9836 RMC320 [R65] IP66:LED-18/36W/4K</b>	
Valgustite andmetabel	5
<b>WE-EF 105-0083 CFT540 [R] IP66:LED-36/36W/4K</b>	
Valgustite andmetabel	6
<b>Välisistseen 1</b>	
Planeerimisandmed	7
Valgustite arvu loend	8
Valgustid (asendiplaan)	9
3D-esitus	10
Valede värvide esitamine	11

Silmani Elekter AS

Kadaka tee 56  
TallinnTöötaja Roland Tolk  
Telefon 6711225  
Faks 6711221  
e-post roland@silman.ee**WE-EF 195-9147 TRO259 IP55:LED-FT 12W/4K / Valgustite andmetabel**

Helendus 1:

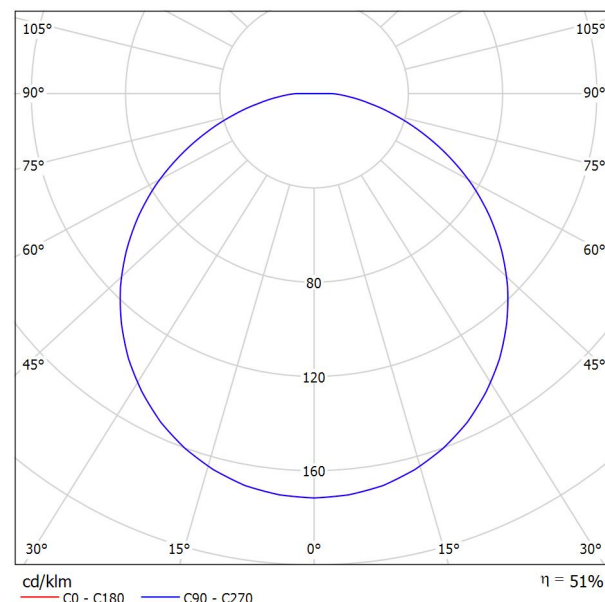
Valgustite klassifikatsiooni alus CIE: 100  
CIE Flux kood: 46 77 94 100 51

IP55, Class I. IK10. Marine-grade die-cast aluminium alloy. 5CE superior corrosion protection including PCS hardware. Silicone rubber gasket. Polycarbonate main lens. Two cable entries.

A pre-installation blackout is available and recommended for mounting in concrete walls. To be ordered separately

Helendus 1:

Pimestuse hinnang UGR järgi										
ρ Lagi	70	70	50	50	30	70	70	50	50	30
ρ Seinad	50	30	50	30	30	50	30	50	30	30
ρ Pörand	20	20	20	20	20	20	20	20	20	20
Ruumi suurus X Y	Vaatesuund risti lambi telje suhtes					Vaatesuund pikuti lambi telje suhtes				
2H	2H	17.7	19.1	18.0	19.3	19.6	17.7	19.1	18.0	19.3
	3H	19.4	20.6	19.7	20.9	21.1	19.4	20.6	19.7	20.9
	4H	20.0	21.2	20.4	21.5	21.8	20.0	21.2	20.4	21.5
	6H	20.6	21.7	21.0	22.0	22.3	20.6	21.7	21.0	22.0
	8H	20.9	21.9	21.2	22.2	22.6	20.9	21.9	21.2	22.2
	12H	21.1	22.1	21.5	22.4	22.8	21.1	22.1	21.5	22.4
4H	2H	18.4	19.6	18.8	19.9	20.2	18.4	19.6	18.8	19.9
	3H	20.3	21.3	20.6	21.6	21.9	20.3	21.3	20.6	21.6
	4H	21.1	22.0	21.5	22.3	22.7	21.1	22.0	21.5	22.3
	6H	21.8	22.6	22.2	23.0	23.4	21.8	22.6	22.2	23.0
	8H	22.1	22.9	22.6	23.3	23.7	22.1	22.9	22.6	23.3
	12H	22.5	23.1	22.9	23.5	24.0	22.5	23.1	22.9	23.5
8H	4H	21.4	22.1	21.9	22.5	23.0	21.4	22.1	21.9	22.5
	6H	22.3	22.9	22.8	23.4	23.8	22.3	22.9	22.8	23.4
	8H	22.8	23.3	23.3	23.8	24.2	22.8	23.3	23.3	23.8
	12H	23.2	23.7	23.7	24.2	24.7	23.2	23.7	23.7	24.2
12H	4H	21.5	22.1	21.9	22.5	23.0	21.5	22.1	21.9	22.5
	6H	22.4	23.0	22.9	23.4	23.9	22.4	23.0	22.9	23.4
	8H	22.9	23.4	23.4	23.9	24.4	22.9	23.4	23.4	23.9
Vaatlaja asukohta variatsioon valgustite kauguste 5 jaoks										
S = 1.0H	+0.1 / -0.1					+0.1 / -0.1				
S = 1.5H	+0.2 / -0.3					+0.2 / -0.3				
S = 2.0H	+0.3 / -0.6					+0.3 / -0.6				
Standardtabel	BK07					BK07				
Korrektuur-liidetav	3.5					3.5				
Korrigeeritud pimestustegurite alus 1600lm Kogu valgusvoog										

Silmani Elekter AS

Kadaka tee 56  
TallinnTöötaja Roland Tolk  
Telefon 6711225  
Faks 6711221  
e-post roland@silman.ee**WE-EF 132-0529 OLV334 [R65] IP65:LED-12/12W/4K / Valgustite andmetabel**

Helendus 1:

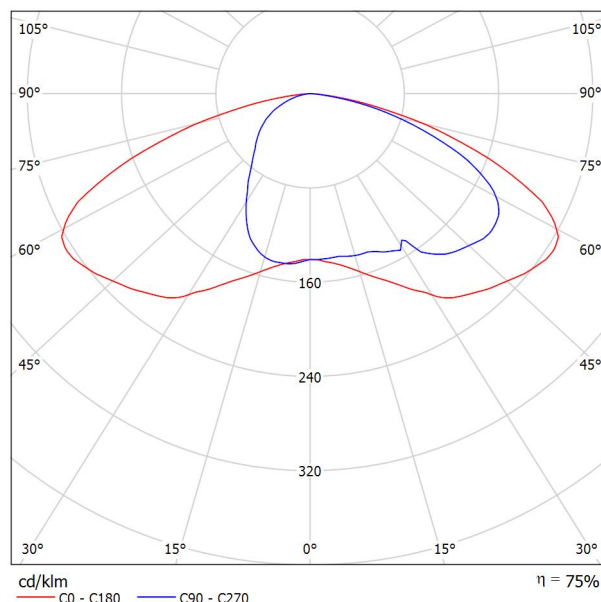
Valgustite klassifikatsiooni alus CIE: 100  
CIE Flux kood: 35 71 95 100 75

IP65, Class I. IK08. Marine-grade die-cast aluminium alloy. 5CE superior corrosion protection including PCS hardware. Silicone rubber gaskets. Safety glass lens. CAD optimised OLC® PMMA lens for superior illumination and glare control. Two cable entries.

Can be mounted up or down.

Puuduvate sümmeetriaomaduste tõttu ei saa selle valgusti kohta UGR-tabelit esitada.

Silmani Elekter AS

Kadaka tee 56  
TallinnTöötaja Roland Tolk  
Telefon 6711225  
Faks 6711221  
e-post roland@silman.ee**WE-EF 105-9836 RMC320 [R65] IP66:LED-18/36W/4K / Valgustite andmetabel**

Helendus 1:

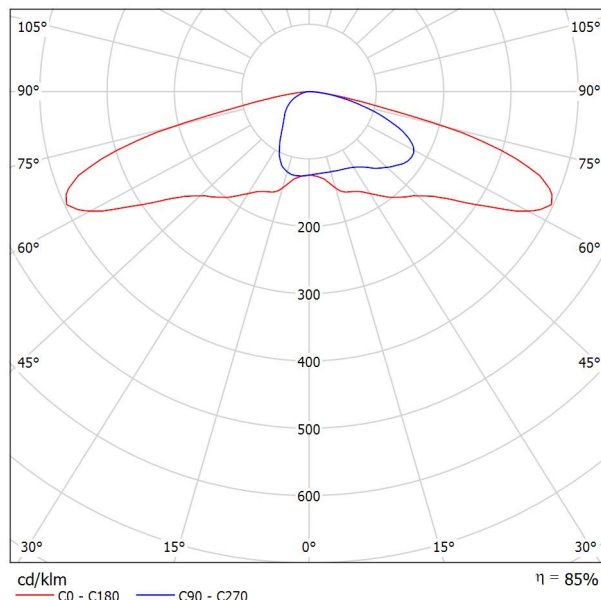
Valgustite klassifikatsiooni alus CIE: 100  
CIE Flux kood: 27 58 92 100 85

IP66. Class I or Class II. IK08. Marine-grade, die-cast aluminium alloy. 5CE superior corrosion protection including PCS hardware. RFC™ Reflection Free Contour main lens. Silicone CCG® Controlled Compression Gasket. Luminaire is factory-sealed and does not need to be opened during installation.

Integral EC electronic converter. Advanced thermal management protects LEDs while optimising lumens output. LED board can be easily removed for upgrading. CAD- optimised OLC® optics for superior illumination and glare control.

Maximum spacing for streetlighting applications depends on wattage and light distribution: 5.5 to 9 times the mounting height.

Puuduvate sümmeetriaomaduste tõttu ei saa selle valgusti kohta UGR-tabelit esitada.

Silmani Elekter AS

Kadaka tee 56  
TallinnTöötaja Roland Tolk  
Telefon 6711225  
Faks 6711221  
e-post roland@silman.ee**WE-EF 105-0083 CFT540 [R] IP66:LED-36/36W/4K / Valgustite andmetabel**

Helendus 1:

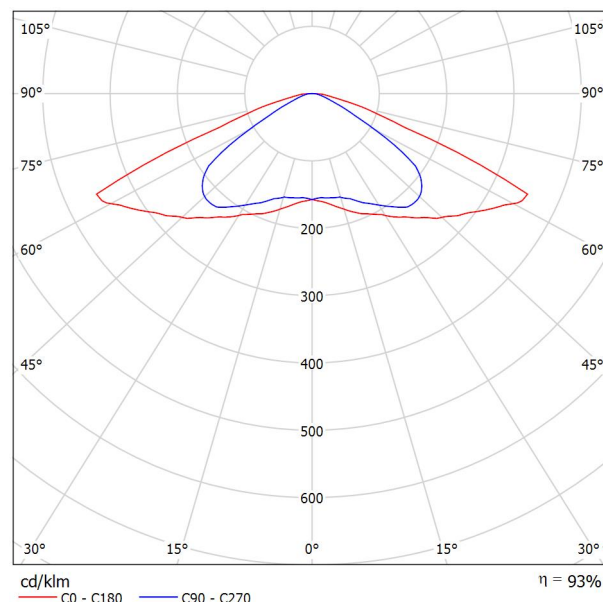
Valgustite klassifikatsiooni alus CIE: 100  
CIE Flux kood: 33 76 97 100 93

IP66. Class I. IK08. Marine-grade, die-cast aluminium alloy. 5CE superior corrosion protection including PCS hardware. RFC™ Reflection Free Contour main lens. Silicone CCG® Controlled Compression Gasket. Luminaire is factory-sealed and does not need to be opened during installation. Integral EC electronic converter. Advanced thermal management protects LEDs while optimising lumens output. LED board can be easily removed for upgrading. CAD- optimised OLC® optics for superior illumination and glare control. Maximum spacing for streetlighting applications depends on wattage and light distribution: 5.5 to 9 times the mounting height.

Available from 1st quartar 2015.

Helendus 1:

Pimestuse hinnang UGR järgi												
ρ Lagi		70	70	50	50	30	70	70	50	50	30	
ρ Seinad		50	30	50	30	30	50	30	50	30	30	
ρ Põrand		20	20	20	20	20	20	20	20	20	20	
Ruumi suurus X Y		Vaatesuund risti lambi telje suhtes					Vaatesuund pikuti lambi telje suhtes					
2H	2H	21.4	22.9	21.7	23.2	23.4	16.7	18.2	17.0	18.4	18.7	
	3H	23.3	24.7	23.7	25.0	25.2	16.8	18.2	17.1	18.4	18.7	
	4H	23.5	24.8	23.9	25.1	25.4	16.8	18.1	17.2	18.4	18.7	
	6H	23.6	24.7	23.9	25.1	25.4	16.8	18.0	17.2	18.3	18.6	
	8H	23.6	24.7	23.9	25.0	25.4	16.8	18.0	17.2	18.3	18.6	
4H	12H	23.6	24.6	24.0	25.0	25.3	16.8	17.9	17.2	18.2	18.6	
	2H	21.8	23.0	22.1	23.3	23.6	18.1	19.3	18.4	19.6	19.9	
	3H	23.8	24.9	24.2	25.2	25.5	18.2	19.3	18.6	19.6	20.0	
	4H	24.1	25.0	24.5	25.4	25.8	18.2	19.2	18.6	19.5	19.9	
	6H	24.2	25.0	24.6	25.4	25.8	18.3	19.1	18.7	19.5	19.9	
8H	8H	24.2	25.0	24.7	25.4	25.8	18.3	19.0	18.7	19.4	19.8	
	12H	24.2	24.9	24.7	25.4	25.8	18.3	19.0	18.7	19.4	19.8	
	4H	24.0	24.8	24.5	25.2	25.6	18.5	19.3	19.0	19.7	20.1	
	6H	24.2	24.8	24.6	25.2	25.7	18.6	19.2	19.1	19.6	20.1	
	8H	24.2	24.8	24.7	25.2	25.7	18.6	19.2	19.1	19.6	20.1	
12H	12H	24.3	24.8	24.8	25.2	25.7	18.7	19.1	19.2	19.6	20.1	
	4H	24.0	24.7	24.4	25.1	25.5	18.5	19.2	19.0	19.6	20.1	
	6H	24.2	24.7	24.6	25.1	25.6	18.6	19.2	19.1	19.6	20.1	
	8H	24.2	24.7	24.7	25.2	25.7	18.7	19.1	19.2	19.6	20.1	
Vaateleja asukoha variatsioon valgustite kauguste 5 jaoks												
S = 1.0H		+0.3 / -0.4					+0.8 / -0.8					
S = 1.5H		+1.4 / -1.3					+1.8 / -3.0					
S = 2.0H		+2.2 / -2.6					+2.7 / -4.9					
Standardtabel		BK04					BK02					
Korrektuur-liidetav		6.9					0.4					
Korrigeeritud pimestustegurite alus 4536lm Kogu valgusvoog												

Silmani Elekter AS

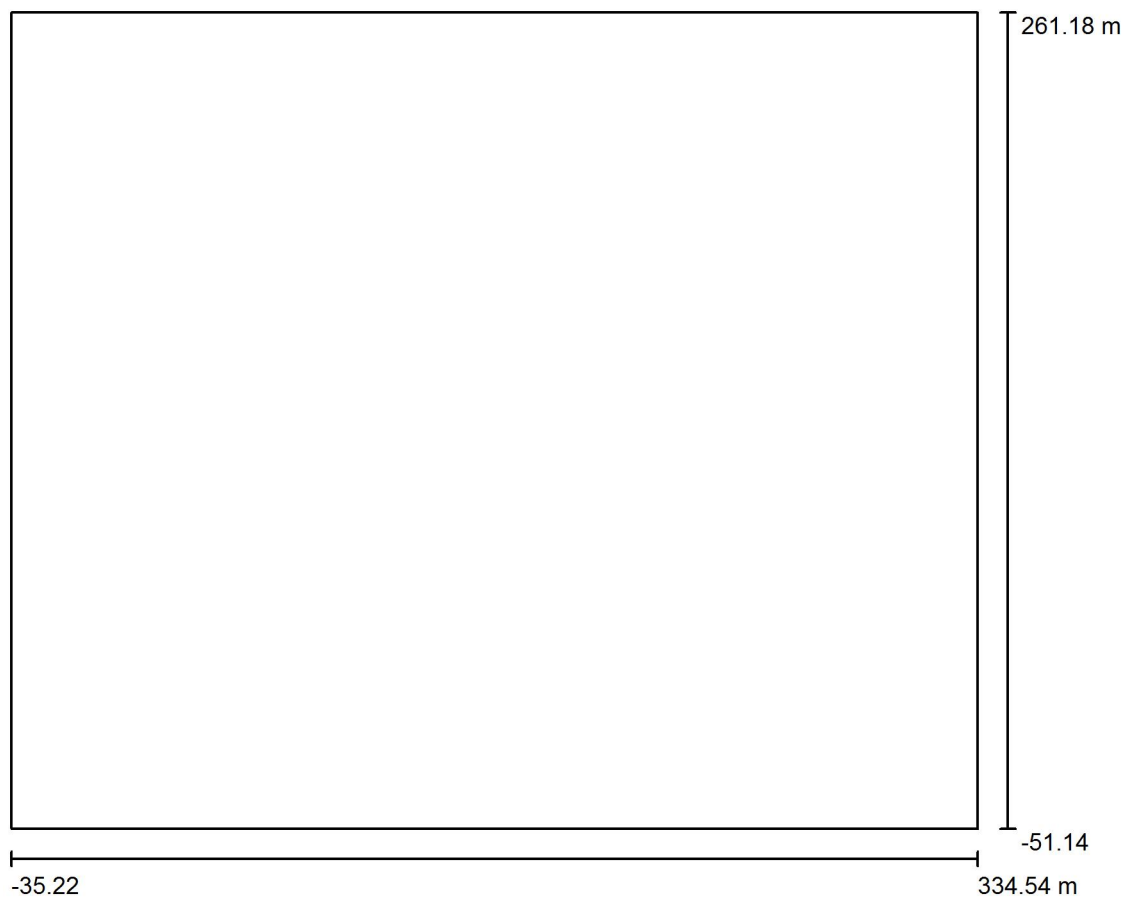
Kadaka tee 56  
TallinnTöötaja Roland Tolk  
Telefon 6711225  
Faks 6711221  
e-post roland@silman.ee**Välisistseen 1 / Planeerimisandmed**

Säilivustegur: 0.90, ULR (Upward Light Ratio): 0.0%

Möötkava 1:2895

**Valgustite loetelu**

Nr.	Tükki	Tähistus (Parandustegur)	$\Phi$ (Valgusti) [lm]	$\Phi$ (Lambid) [lm]	P [W]
1	9	WE-EF 105-0083 CFT540 [R] IP66:LED-36/36W/4K (1.000)	4234	4536	42.0
2	2	WE-EF 105-9836 RMC320 [R65] IP66:LED-18/36W/4K (1.000)	3514	4147	39.0
3	6	WE-EF 132-0529 OLV334 [R65] IP65:LED-12/12W/4K (1.000)	1133	1512	15.0
4	4	WE-EF 195-9147 TRO259 IP55:LED-FT 12W/4K (1.000)	812	1600	15.0
Kokku:			55182	64590	606.0

Silmani Elekter AS

Kadaka tee 56  
TallinnTöötaja Roland Tolk  
Telefon 6711225  
Faks 6711221  
e-post roland@silman.ee

## Välisistseen 1 / Valgustite arvu loend

9 Tükki WE-EF 105-0083 CFT540 [R] IP66:LED-36/36W/4K  
Artikli nr.: 105-0083  
Valgusvoog (Valgusti): 4234 lm  
Valgusvoog (Lambid): 4536 lm  
Valgusti võimsus: 42.0 W  
Valgustite klassifikatsiooni alus CIE: 100  
CIE Flux kood: 33 76 97 100 93  
Varustatus: 36 x LED-36/36W/740 - 4000K  
(Parandustegur 1.000).

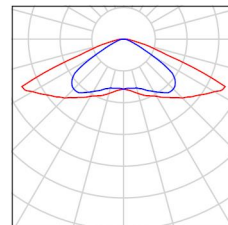

2 Tükki WE-EF 105-9836 RMC320 [R65] IP66:LED-18/36W/4K  
Artikli nr.: 105-9836  
Valgusvoog (Valgusti): 3514 lm  
Valgusvoog (Lambid): 4147 lm  
Valgusti võimsus: 39.0 W  
Valgustite klassifikatsiooni alus CIE: 100  
CIE Flux kood: 27 58 92 100 85  
Varustatus: 18 x LED-18/36W/740 - 4000K  
(Parandustegur 1.000).

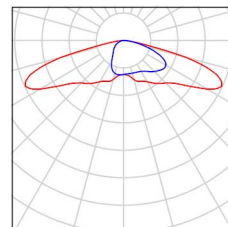

6 Tükki WE-EF 132-0529 OLV334 [R65] IP65:LED-12/12W/4K  
Artikli nr.: 132-0529  
Valgusvoog (Valgusti): 1133 lm  
Valgusvoog (Lambid): 1512 lm  
Valgusti võimsus: 15.0 W  
Valgustite klassifikatsiooni alus CIE: 100  
CIE Flux kood: 35 71 95 100 75  
Varustatus: 12 x LED-12/12W/740 - 4000K  
(Parandustegur 1.000).

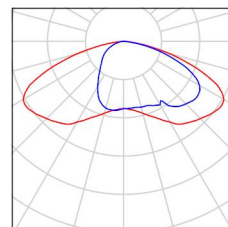

4 Tükki WE-EF 195-9147 TRO259 IP55:LED-FT 12W/4K  
Artikli nr.: 195-9147  
Valgusvoog (Valgusti): 812 lm  
Valgusvoog (Lambid): 1600 lm  
Valgusti võimsus: 15.0 W  
Valgustite klassifikatsiooni alus CIE: 100  
CIE Flux kood: 46 77 94 100 51  
Varustatus: 1 x LED-FT-12W - 4000K  
(Parandustegur 1.000).

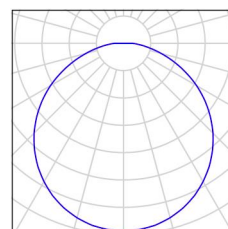

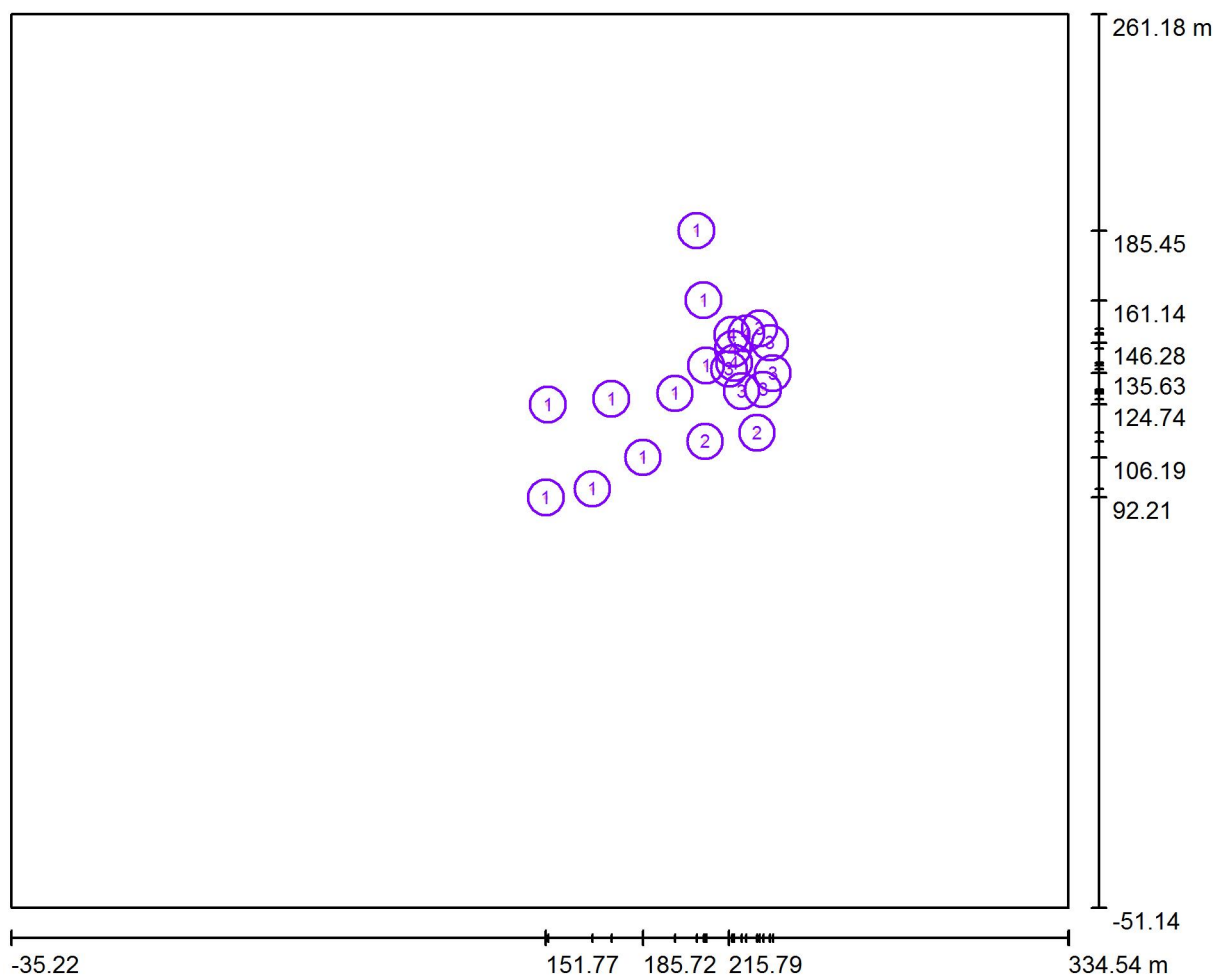

Silmani Elekter AS

Kadaka tee 56  
TallinnTöötaja Roland Tolk  
Telefon 6711225  
Faks 6711221  
e-post roland@silman.ee**Välisistseen 1 / Valgustid (asendiplaan)**

Mõõtkava 1 : 2644

**Valgustite loetelu**

Nr.	Tükki	Tähistus
1	9	WE-EF 105-0083 CFT540 [R] IP66:LED-36/36W/4K
2	2	WE-EF 105-9836 RMC320 [R65] IP66:LED-18/36W/4K
3	6	WE-EF 132-0529 OLV334 [R65] IP65:LED-12/12W/4K
4	4	WE-EF 195-9147 TRO259 IP55:LED-FT 12W/4K

Silmani Elekter AS

Kadaka tee 56  
Tallinn

Töötaja Roland Tolk  
Telefon 6711225  
Faks 6711221  
e-post roland@silman.ee

## Välisistseen 1 / 3D-esitlus

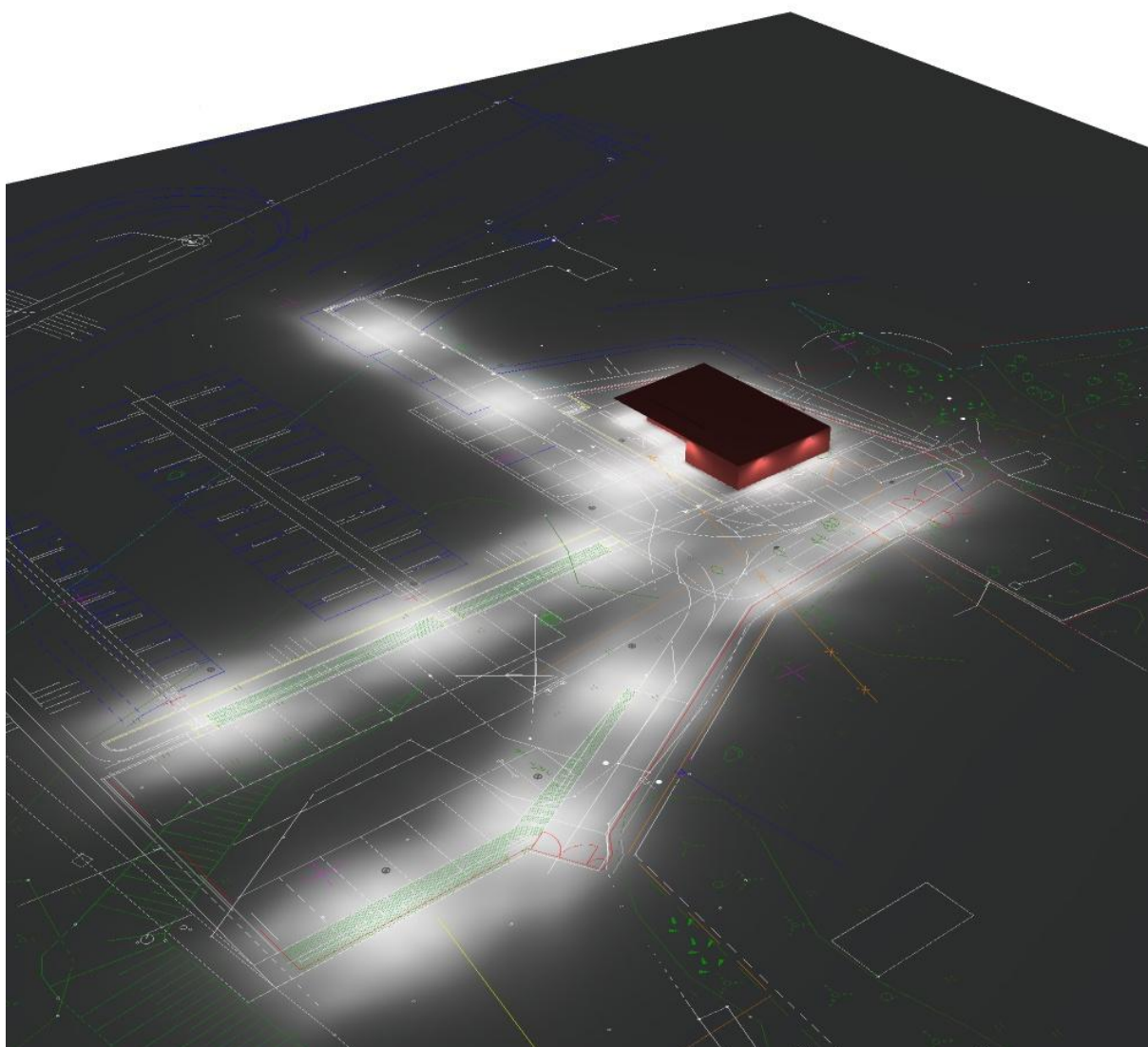

Silmani Elekter AS

Kadaka tee 56  
Tallinn

Töötaja Roland Tolk  
Telefon 6711225  
Faks 6711221  
e-post roland@silman.ee

## Välisistseen 1 / Valede värvide esitamine

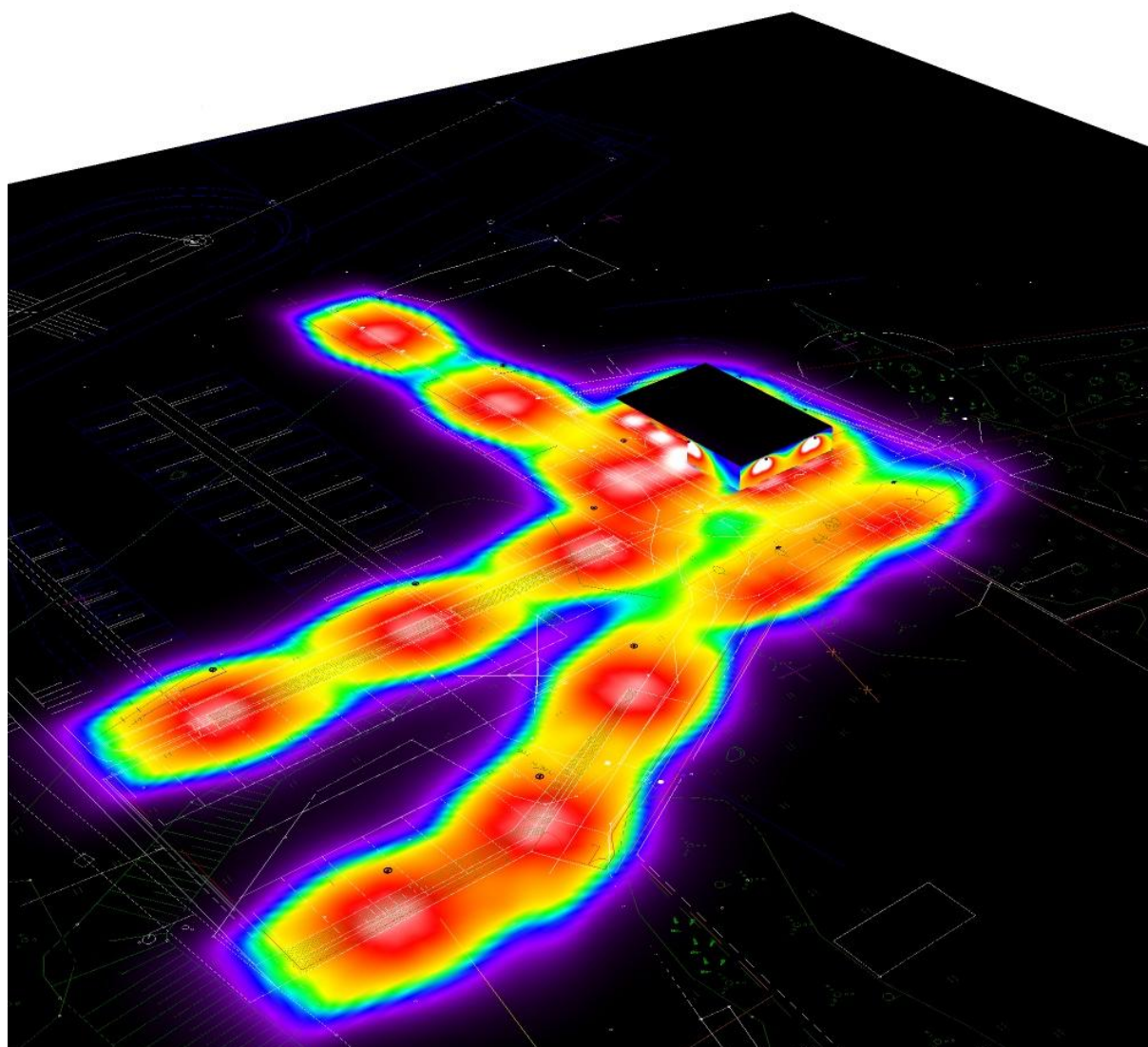

0.10 1.34 2.58 3.81 5.05 6.29 10 20 30 lx